



CATALOGUE

WINDOWS AND EXTERIOR DOORS



"Perfection is achieved, not when there is nothing more to add, but when there is nothing left to take away."

Antoine de Saint-Exupéry

INTERACTIVE CATALOGUE

To learn more, follow the instructions:

Windows

MESTRE RAPOSA
WINDOWS AND EXTERIOR DOORS

06

If you want to see only one of the subjects in the catalogue, click on that subject to access the corresponding page.

When you are browsing the catalogue and want to return to the Index, just click on **Mestre Raposa**, which is at the top of the page.

If you want to go forward or return, click on **the page number** on the left or right.

INDEX

Our Story	03
Windows	
	Wood Range 06
	Wood-Aluminium Range 14
	PVC Range 17
Entrance Door	
	Wood Range 18
	Wood-Aluminium Range 21
	PVC Range 22
Shutters	24
Electric Shutters	25
Roller Shutters	26
Types of Glass	28
Available Colours	
	Wood Range 30
	Aluminium Range 31
	PVC Range 32
Modern Handles	34
Traditional Handles	37
Types of Installation	39
Window Protection Maintenance	40
Mestre Raposa Warranty	41

OUR STORY

Founded more than 15 years ago, Mestre Raposa is one of the main companies of reference in the windows and doors market in Portugal, with over 5000 successful projects to our name.

Our success is due to a combination of years of dedication to our bussiness, our experience, the quality of our products and our search for excellence in our installation service, and at all times respecting the highest German standard and procedures.

We are proud to say that the houses in the most beautiful and exclusive areas of southern Portugal are equipped with our windows and doors.

15
years of experience

5000
projects

60
employees



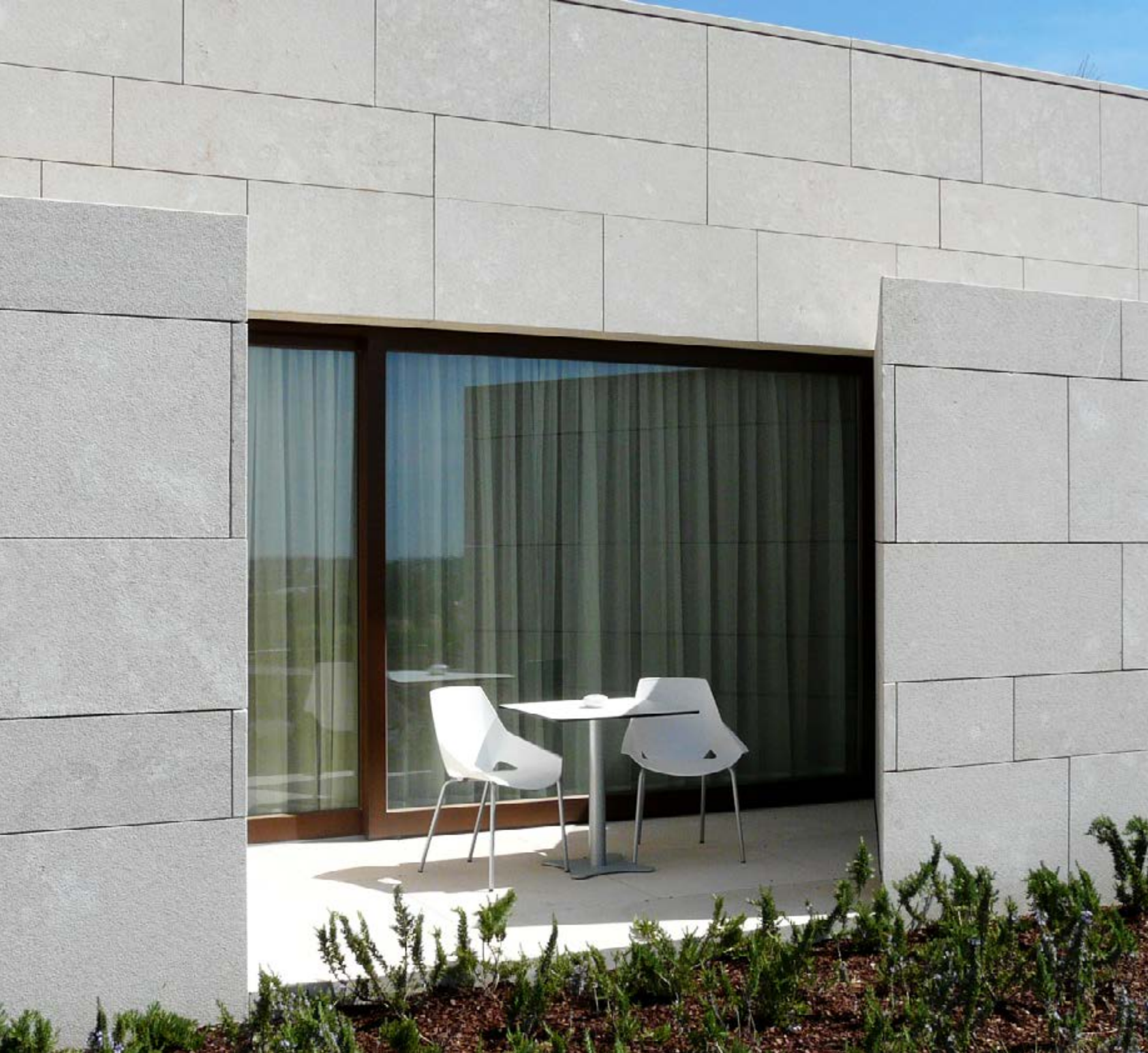

WOOD RANGE

Standard Profile
Traditional Window
Balcony Door
Lift & Slide Door
Bi-folding Door
Entrance Door

WOOD-ALUMINIUM RANGE

Classic Profile
Linear Profile
Quadrat Profile
Soft Line Profile
Retro Profile
Passive MR Profile

PVC RANGE

Brüggmann bluEvolution: 82 AD
PVC Alu Look + PVC Wood Look

WINDOWS

WOOD WINDOWS

Mestre Raposa's wood windows can be completely bespoke in what size and shape is concerned, to fit any design or architectural style. They are available in a wide variety of woods, colours and finishes, including different coatings, varnishes and impregnations. With good thermal and acoustic insulation, it also offers protection against the weather and its elements, due to our special surface treatment. Highly durable, they are resistant to continuous wear and tear but, because our homes and tastes change with time, they can always be altered with different colours and finishes, so you never get tired of them!

Wooden windows are becoming more and more popular, thanks to the combination of qualities such as their resistance, excellent technical performances and ecological features, but also because of their aesthetic and versatility – they satisfy all the requirements of the historic preservation of buildings but can also be used in the most modern and cutting-edge architectural projects.

WOOD

Choosing wood windows is choosing a 100% recyclable material and cherishing the environment and its resources. Wood prevents static electricity, thus decreasing the possibility of getting those annoying shocks in cold or dry weather, and it presents excellent static quality in what expansion and contraction when exposed to extreme temperatures – in both cold and heat – is concerned. Choosing wood windows is choosing a 100% recyclable material and cherishing the environment and its resources. Wood prevents static electricity, thus decreasing the possibility of getting those annoying shocks in cold or dry weather, and it presents excellent static quality in what expansion and contraction when exposed to extreme temperatures – in both cold and heat – is concerned.



WOOD TYPES



Pine
Uf = 1,3 W/(m²K)



Oak
Uf = 1,4 W/(m²K)



Larch
Uf = 1,3 W/(m²K)



Meranti
Uf = 1,4 W/(m²K)

Profile: Triple laminated, resistance DIN EN 204 (D4)



Pine
Uf = 1,3 W/(m²K)



Oak
Uf = 1,4 W/(m²K)



Larch
Uf = 1,3 W/(m²K)



Meranti
Uf = 1,4 W/(m²K)

Hardware: GU, Siegenia, Maco ou Roto

Anti-intrusion



RC1

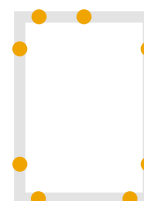

RC2



RC3



Air permeability
Class 4



Water tightness
Class 9A



Wind resistance
Class C3

System certified by:

FCBA, l'Institut Technologique Forêt Cellulose Bois-construction Ameublement
Window MR 68 tested by FCBA, test report AEV FCBA n° 404/18/75/9555-1 to 31/05/2018
Passive Window MR 68 tested by FCBA, test report AEV FCBA n° 404/18/75/9555-2 to 31/05/2018

Itecons - Instituto de Investigação e Desenvolvimento Tecnológico para a Construção, Energia, Ambiente e Sustentabilidade
Reports: CXL036/18, CXL039/18, CXL040/18 to 27/03/2018

Standard Profile

Ref: MR 68, MR 78, MR 88
Available in:
Pine, Oak, Larch, Meranti

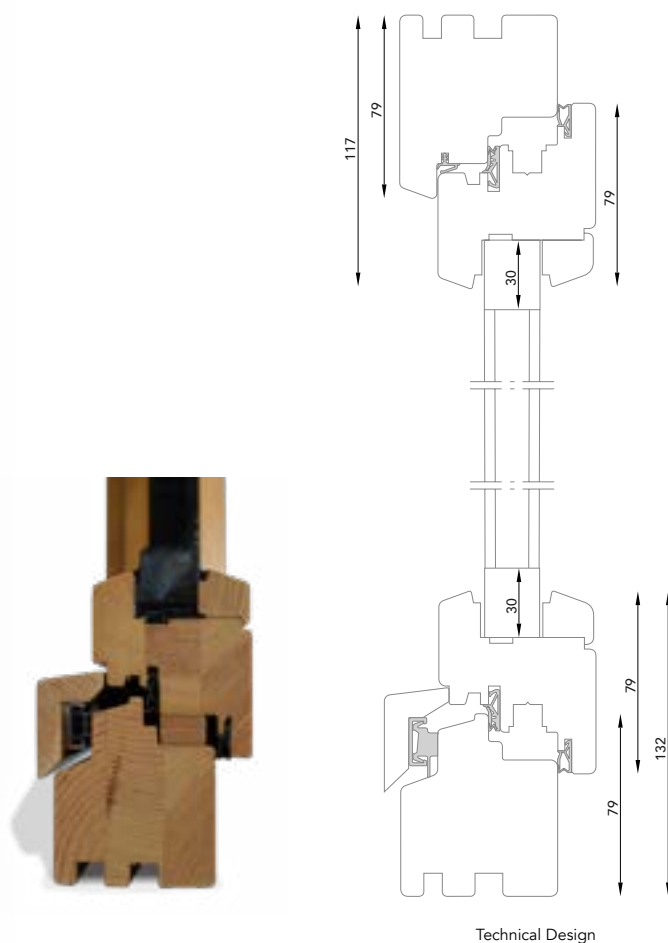

RAIN SHIELD

Standard
Ref: 401

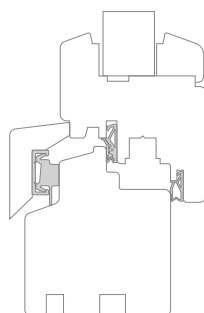

Aluminium
Ref: 402

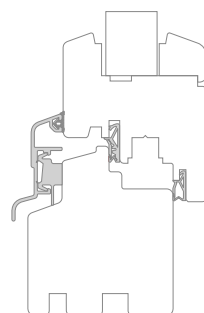

Retro
Ref: 403

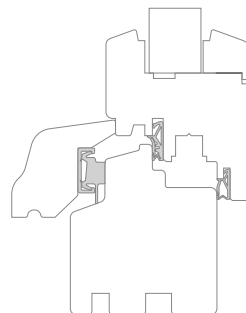

Modern
Ref: 404

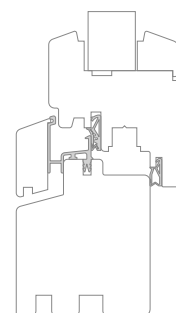

TRADITIONAL WINDOW

Ref: MR 67G



CHARACTERISTICS

- Double Glazing: 26mm (4+16 Argon/warm edge+6)
- Glazing Bars: On the glass, in space bar inside the glass
- Finish: Paint, Varnish

VENTILATION GRILLS FOR TIMBER WINDOW PROFILES

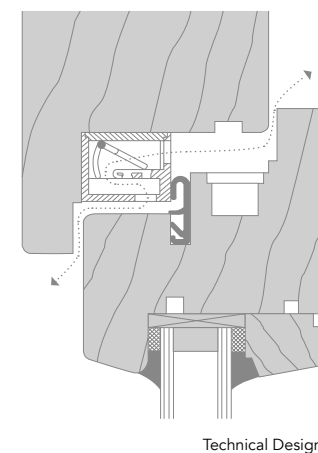

Regel-Air H - Type 24

A perfectly adapted solution to improve the circulation of air.

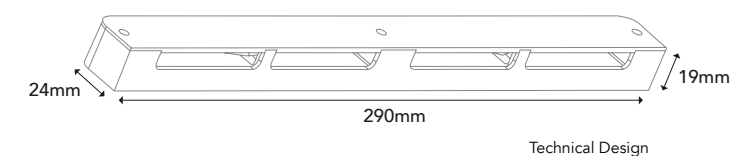

The ventilation grills are not visible on the inside or outside of the window. Thus, the design of the window does not change with the inclusion of ventilation system, as usually happens with other traditional ventilation systems.

BALCONY DOOR

Ref: MR 68, MR 78, MR 88



CHARACTERISTICS

- Double Glazing: 26mm (4+16 Argon/warm edge+6)
- Glazing Bars: On the glass, in space bar inside the glass
- Finish: Paint, Varnish

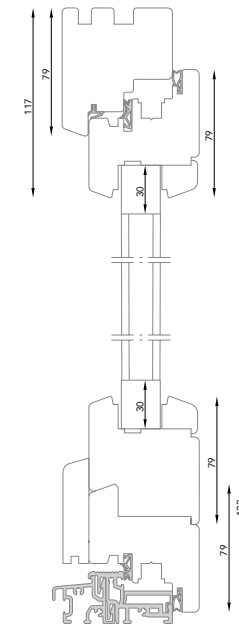

Technical Design

ALUMINIUM THRESHOLD FOR BALCONY DOOR

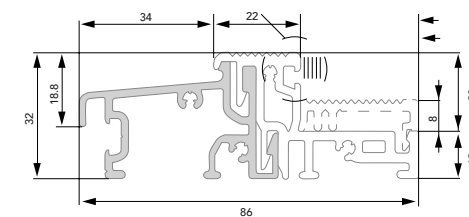

Technical Design

PANEL TYPES



Raised
Ref: 061

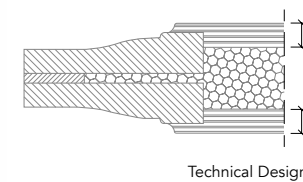

Technical Design



Flat
Ref: 062

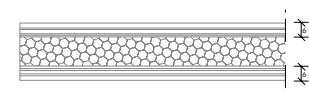

Technical Design



Squared
Ref: 063

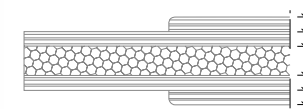

Technical Design



Vertical Slats
Ref: 064

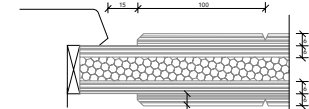

Technical Design

LIFT & SLIDE DOOR

Ref: MR 68LC, MR 88LC

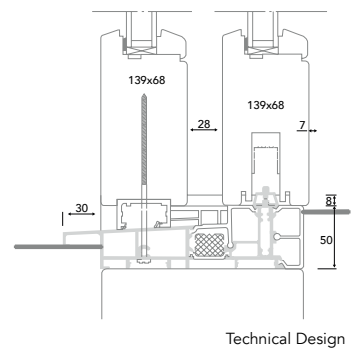
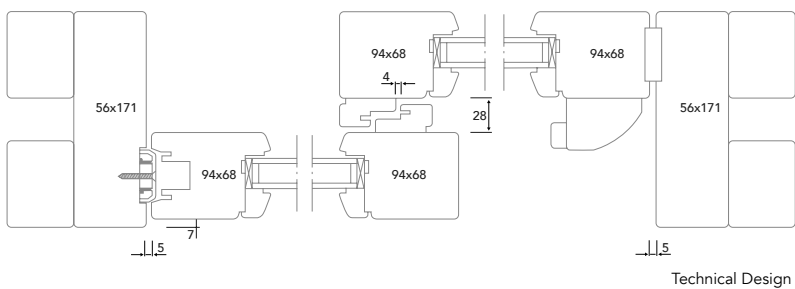

Schematics



BI-FOLDING DOORS

Ref: MR 68PC, MR 78PC, MR 88PC

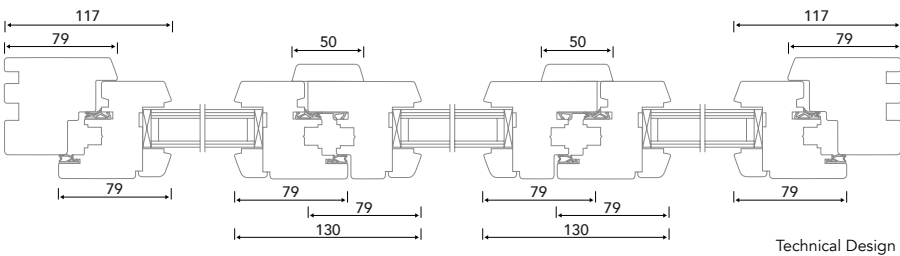

Schematics



WOOD-ALUMINIUM



Pine
Uf = 0,9 W/(m²K)



Oak
Uf = 0,9 W/(m²K)



Larch
Uf = 0,9 W/(m²K)



Meranti
Uf = 0,9 W/(m²K)

Profile: Interior: Triple laminated, resistance DIN EN 204 (D4)
Exterior: Aluminium



Pine
Uf = 0,9 W/(m²K)



Oak
Uf = 0,9 W/(m²K)



Larch
Uf = 0,9 W/(m²K)



Meranti
Uf = 0,9 W/(m²K)

Hardware: GU, Siegenia, Maco ou Roto

Anti-intrusion

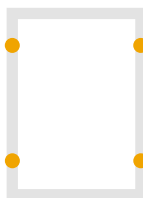

RC1

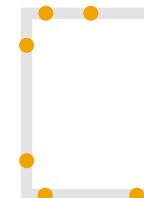

RC2

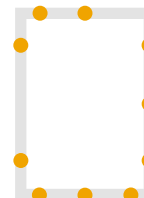

RC3

System certified by:

FCBA, l'Institut Technologique Forêt Cellulose
Bois-construction Ameublement

Window MR 68 tested by FCBA, test report AEV FCBA
n° 404/18/75/9555-1 du 31/05/2018

Passive Window MR 68 tested by FCBA, test report AEV FCBA
n° 404/18/75/9555-2 du 31/05/2018

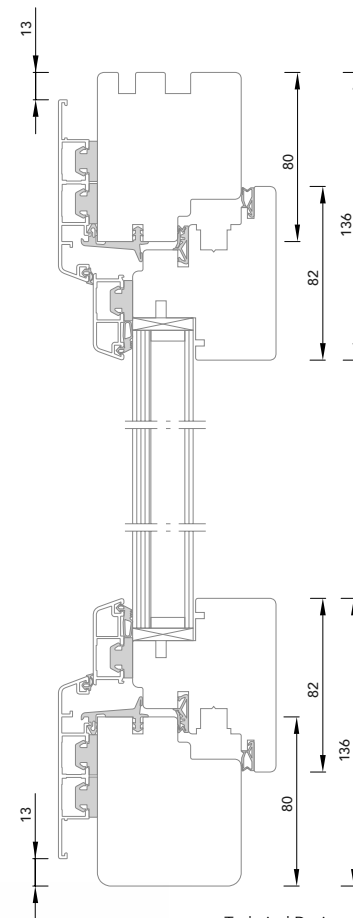

Technical Design



Air permeability
Class 4



Water tightness
Class 9A



Wind resistance
Class C3

Classic Profile

Available in:
MR 68 et MR 88



Passive MR Profile

Available in:
MR 68

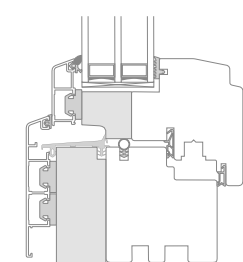

Technical Design

OPTIONS:

Linear Profile



Quadrat Profile



Soft Line Profile



Retro Profile



UPVC

73 AD

Ref: MR 73AD

CHARACTERISTICS

- 5 chambres
- Profile Depth: 73mm
- Glass: Double glazing SGG Climalit – 1,1
- Sound insulation: up to 34 dB
- Anti-intrusion: RC 2

Thermal insulation profile: with integrated "Warm Edge"

Helps reduce energy costs and contributes significantly to the reduction of CO2 emissions. It significantly improves the insulation properties of the glass and reduces the Uw value. The space between the glasses now has a more elegant look.

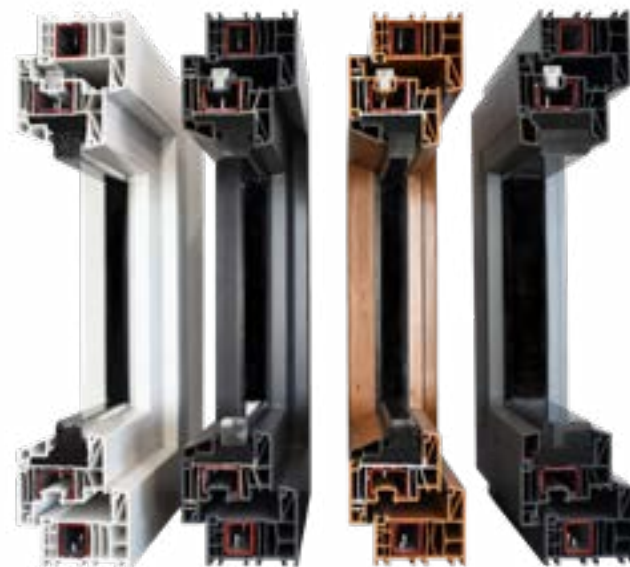

PVC ALU LOOK + PVC WOOD LOOK

Ref: MR 82ADAL, MR 82ADW



PVC windows with aluminium or wood look.

Mestre Raposa offers an innovative PVC solution: you can choose between the timeless elegance of wood or the modern appearance of aluminium. A wide selection of exceptional films gives PVC windows the same look as wood or aluminium windows and defines the style of the product indoors or outdoors. The look in wood or aluminium are applied in PVC windows made with German SALAMANDER Brügmann 6-chamber profiles with 82mm installation depth and angled edges. This PVC window model has superior quality performance.



UPVC

Slim Line

Ref: MR SlimLine

CARACTERÍSTICAS:

- New UPVC window
- More 30% of natural light
- Extremely thin frame
- New handle
- $U_w = 0,89W(m^2K)$



COOL COLOURS

Mestre Raposa uses Skai Cool Colours – Significant reduction in the heating of the profiles in strong sunlight. Reflection up to 80% of the near-infrared radiation of sunlight and reduction of their heating by 20% or more. Made in Germany.

Na página 32 encontram-se todas as cores da gama de PVC de Cool Colours.

[Clique aqui para ir para a gama de cores.](#)



ENTRANCE DOORS

Our entry doors address all the requirements needed in high quality residential doors.

They bring to every home an inimitable and welcoming charm, whether in a more contemporary style or with more classic elements and thanks to its unique hi-tech design can have different sizes and standard rectangular or non-standard shapes, arched or oblique. For each of your designs, you can combine shape and colour to your expectations, from a wide range of colours and finishes. Our profiles allow the use of different handles and special hinges (see p. 34).

Mestre Raposa's entrance doors have a security lock with 5 locking points and 3 anti-locking hinges adjustable in three dimensions. In addition, they can be equipped with several anti-intrusion options, up to RC2, which can include laminated glass units and grills that decorate and protect at the same time.

WOOD

Our wood entrance doors are made of triple laminated profile, with a cross section of 68x100mm and can be opened inwards or outwards.

The height can reach up to 3000mm and its width can range from 900mm to 1200mm for a single wood entry door (1 sheet) and from 1600mm to 2400mm for a double wood entry door (with 2 sheets). Our profiles allow the usage of different sets of knobs and special hinges that can withstand up to 160kg.

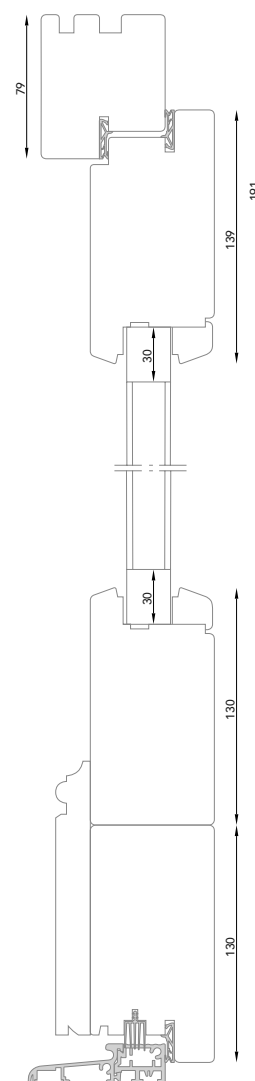

Technical Design

ALUMINIUM FLOOR THRESHOLD FOR ENTRANCE DOORS



Technical Design



Ref: 1001



Ref: 1002



Ref: 1003



Ref: 1004



Ref: 1005



Ref: 1006



Ref: 1007



Ref: 1008



Ref: 1009



Ref: 1010



Ref: 1011



Ref: 1012

WOOD-ALUMINIUM



Ref: 1013



Ref: 1014



Ref: 1015



Ref: 1016



Ref: 1017



Ref: 1018



Ref: 1019



Ref: 1020



Ref: 2001



Ref: 2002



Ref: 2003



Ref: 2004



Ref: 2005



Ref: 2006



Ref: 2007



Ref: 2008

MODELS OF GRILL

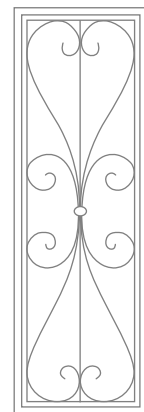

Prado
Ref: 301

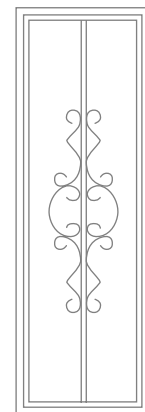

Noblesse
Ref: 302

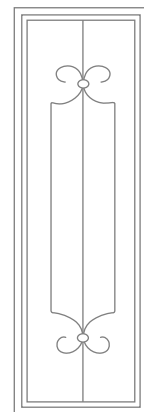

Tradition
Ref: 303

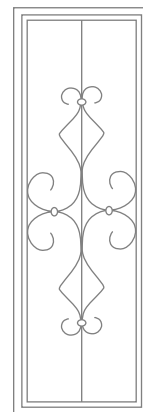

Camargue
Ref: 304

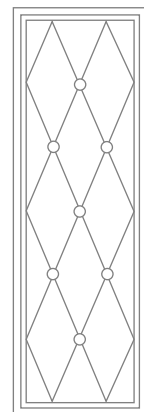

Savoie
Ref: 305

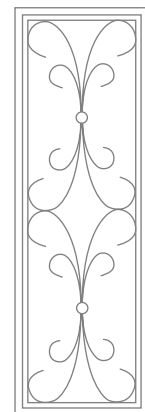

Malte
Ref: 306

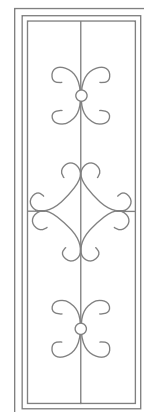

Lorraine
Ref: 307

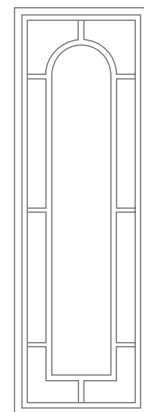

Lisieux
Ref: 308

Our wood-aluminium doors are made with triple laminated profile, and have a high-strength aluminium exterior.

With this flexible combination, it has on the outside, a modern aluminium door that excels in robustness and design, and, inside, a charming wood door that creates a cosy atmosphere. The Mestre Raposa wood-aluminium entrance doors are the ideal solution for a contemporary and also traditional style, with almost no limitations.

PVC

TECHNICAL INFORMATION

Mestre Raposa PVC entrance doors feature high structural stability.

In this 6-chamber insulation system, with a full-sized steel reinforcement which can be placed in the most optimum position, even in the middle of the profile, between the inner and outer chambers, thus perfectly isolating it from heat and cold.

The PVC door panel is also important for thermal and acoustic insulation. The structure of the panels directly influence the look and durability of your PVC door.

Panel Structure

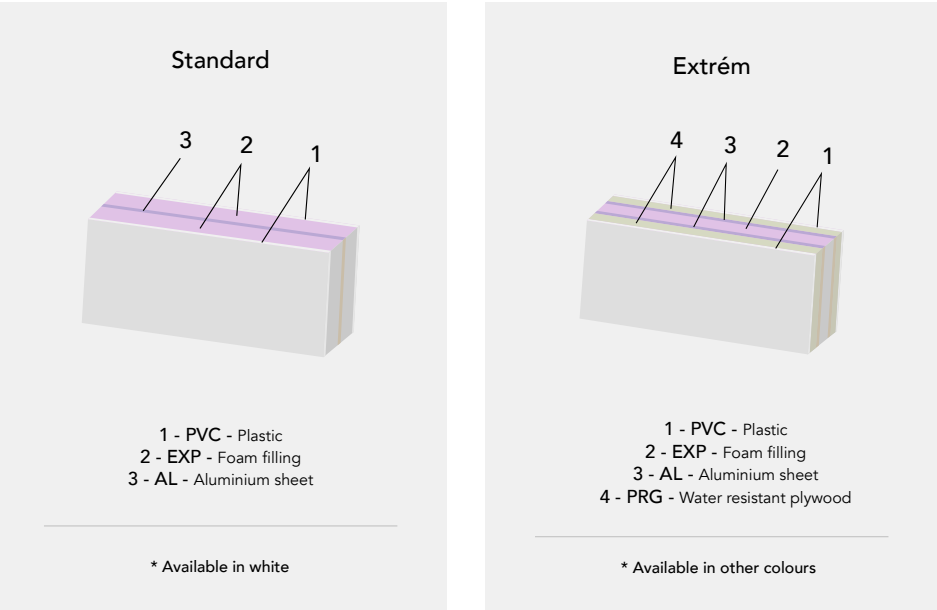

Range of colours available for PVC entrance doors

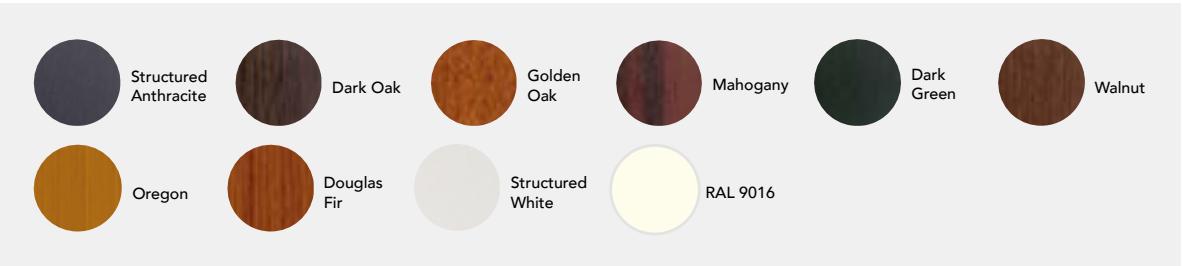

* If you have questions about matching, see pages 36 and 37.

** The minimum width can differ depending on the type of model, from 700mm to 950mm.



Ref: 3001



Ref: 3002



Ref: 3003



Ref: 3004



Ref: 3005



Ref: 3006



Ref: 3007



Ref: 3008



Ref: 3009



Ref: 3010



Ref: 3011



Ref: 3012

SHUTTERS

External



Internal



Dimentions

	Interior	Exterior
Sheet thickness	24 mm	45 mm
Width of vertical blades	-	10 mm x 50 mm
Width of bar	60 mm	80 mm
Thickness of bar	60 mm	-

Type of installation

Minimum height: 1190 mm - Maximum height: 2990 mm

CONFIGURATION	WIDTH IN MM
1 wing	290 to 1000
2 wings	600 to 2000
2 folding wings	600 to 1200
3 folding wings	900 to 1800
4 folding wings	1200 to 2400

* Height to be defined based on individual situations.

TYPE OF ASSEMBLY
Closing or Bi-folding

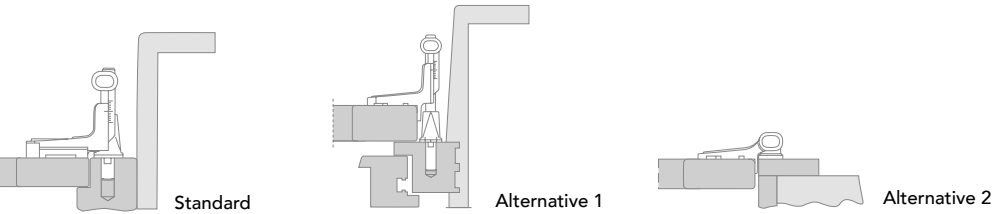

HARDWARE



ELECTRONIC SHUTTERS

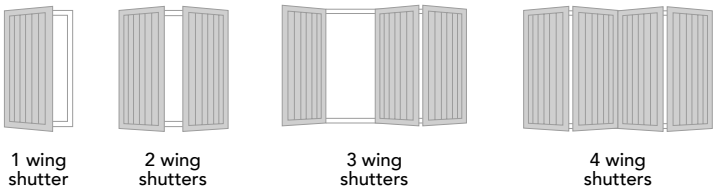

The + points of Somfy systems

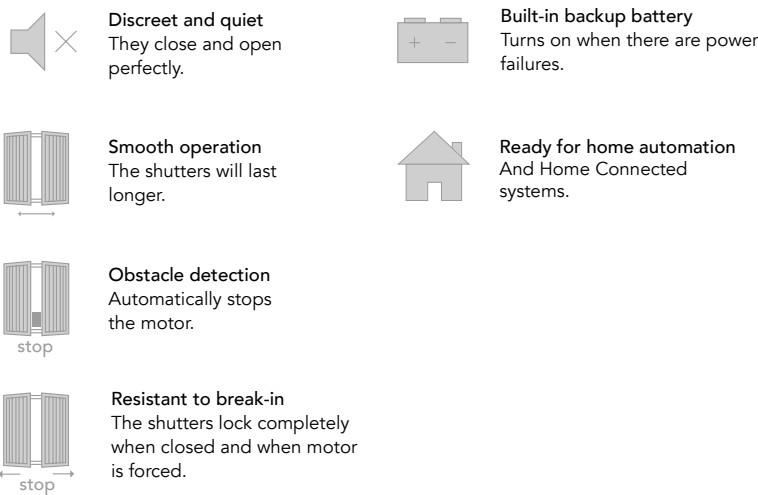

ROLLER SHUTTERS

SYSTEM A
Ref: 091

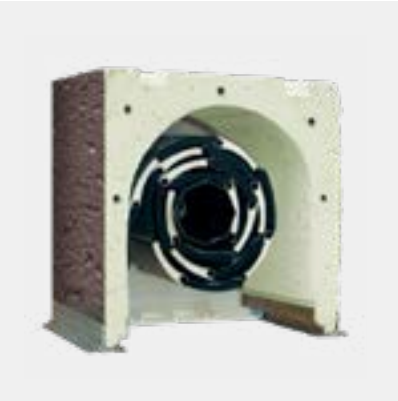

Maximum width: 3000 mm

SYSTEM B
Ref: 092



Maximum width: 3000 mm

SYSTEM C
Ref: 093



Maximum width: 2000 mm

MONOTEC SWITCH
Ref: 099



ECOOOL



Command Ecool 1 channel
Ref: 100
Command Ecool 5 channels
Ref: 101
Command Ecool 1 channel with screen
Ref: 102

COOL



Command Cool 1 channel
Ref: 103
Command Cool 5 channels
Ref: 104
Command Cool 15 channels
Ref: 105

COMMANDS

Command 1 channel
Ref: 095



Command 1 channel with brightness sensor
Ref: 096



Command 5 channel + 1 central control
Ref: 097



Command 15 individual channels + 5 group channels + 1 central control
Ref: 098



Colours: Silver, Anthracite and White

TECHNICAL CHARACTERISTICS	FC42	FC55
Profile dimension	42 x 8.5	55 x 12.3
Number of profiles per meter and height	25	18
Weight per M2 (kg)	3.3	3.9
Recommended maximum height (m)	3	3
Recommended maximum width (m)	2.8	3.5
Recommended maximum surface area (m2)	6.0	7.5
Thickness of lacquered aluminium	0.30	0.33
Polyurethane density (kg/m3)	75	75

COLOURS / SLATS	FC42	FC55
White RAL 9003	N	
Green RAL 6005	E	
Aluminium RAL 9006	E	
Cinch RAL 7011	E	
Cream RAL 1015	N	
Blue RAL 5013	S	
Bordeaux RAL 3005	E	
Grey Slate RAL 7015	E	
Grey Anthracite RAL 7016	E	
Grey Graphite RAL 7024	E	
Light Grey RAL 7035	E	
Grey Traffic RAL 7042	S	
Telegris RAL 7047	S	
Champagne	S	

Colours usually in stock
Colours normally available in stock, but subject to confirmation
N Normal
E Special
S Super

TYPES OF GLASS

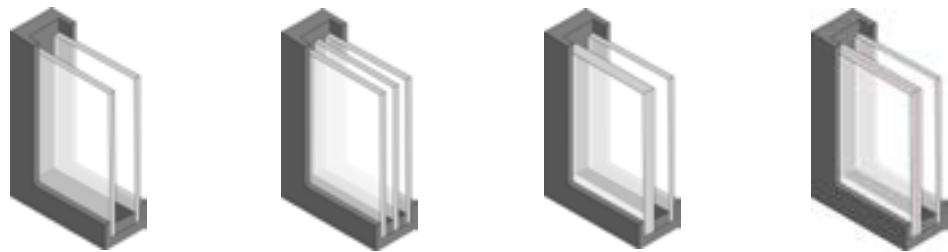

	DOUBLE GLAZED STANDARD GLASS	TRIPLE GLAZED GLASS	DOUBLE GLAZED SOUND CONTROL GLASS	DOUBLE GLAZED SECURITY GLASS
	6/16 ARG/4 thermo	4/16 ARG/4/16ARG/6	10/16 ARG/4 thermo	44.2/16 ARG/4 thermo
Ug	1.1	0.9	1.1	1.0
Sw	81%	75%	70%	70%
g	61%	58%	38%	47%
Rw (dBa)	35	32	37	37

Other types of glass

	4 Cool-Lite SKN 176 II	4 Cool-Lite SKN 176 II + 16 + 6	6 Cool-Lite SKN 176 II + 16 + 10	6 Cool-Lite Extreme 60-28 + 16 + 44-2
Ug	0.8	1.0	1.0	1.0
Sw	64%	70%	69%	59%
g	35%	37%	37%	28%
Rw (dBa)	36	35	39	37

Ug - Coefficient: Refers to the thermal insulation of the glass.

Sw - Coefficient: Refers to the solar transmission performance.

g - Solar Factor: Expresses the global transmission of energy, ie the total amount of solar energy passing through a glazed window and its contribution to the heating of the room.

Rw coefficient (dBa): Is the sound insulation index, which shows the ability of a glazed window to block the transmission of sounds from outside.

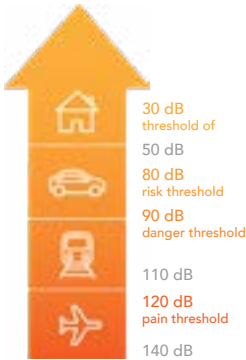

GLASS DECORATION



Antique clair
Ref: 011

Chinchilla
Ref: 012

Satinovo
Ref: 013

Silvit clair
Ref: 014



Delta clair
Ref: 015

Madera
Ref: 016

Water drop
Ref: 017

Delta mat
Ref: 018



Gothique
Ref: 019

Cathedral
Ref: 020

Master carré
Ref: 021

Niagara clair
Ref: 022

INTEGRATED "WARM EDGE"



Available colours:

- RAL 9016
- RAL 8003
- RAL 9005
- RAL 7035
- RAL 8016

GLAZING BARS

Integrated spacer



Standard Ref: 201 Traditional Ref: 202 Retro Ref: 203



Glazing Bars incorporated in aluminium



Incorporated 10mm
White Ref: 001

Incorporated 10mm
Plomb Ref: 002

Incorporated 10mm
Laiton Ref: 003

Incorporated 26mm
Two colors
int. and ext. Ref: 004

Incorporated 26mm
White Ref: 005

Incorporated 45mm
White Ref: 006



Mahogany
Ref: 515



Walnut
Ref: 510



Kempas
Ref: 511



Assamela
Ref: 512



Cherry Tree
Ref: 513



Wenge
Ref: 514



Sipo
Ref: 505



Idigbo
Ref: 506



Sapelli
Ref: 507



Oak
Ref: 508



Calvados
Ref: 509



Stone Pine
Ref: 500



Old Pine
Ref: 501



Cypress
Ref: 502



Iroko
Ref: 503



Chestnut
Ref: 504

RANGE OF COLOURS - WOOD

* Available in matt varnish or glossy varnish.



1-19
Ref: 553



1-20
Ref: 554



1-21
Ref: 556



1-26
Ref: 557

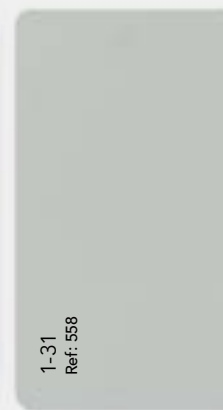

1-31
Ref: 558



1-01
Ref: 550



1-07
Ref: 551



1-10
Ref: 552

RANGE OF COLOURS

WOOD, ALUMINIUM AND PVC

We have a wide range of finishes of all types of wood, in addition to the sixteen colours (left page), there are still the options of matt or gloss lacquer.

There are also eight colours for the aluminium finish (right page).
In the next two pages, there are forty-four colours for PVC.

Make your choice, you're sure to find the right colour for your home

RANGE OF COLOURS - ALUMINIUM

ALUMINIUM IMITATION

WOOD IMITATION

Structured Light Grey Ref: 614	Structured Grey Ref: 619	Structured Metbrush Alu Ref: 613	Structured Basalt Grey Ref: 617	Satin Basalt Grey Ref: 618

Structured Vintage Oak Ref: 609	Sheffield Light Oak Ref: 620

Winchester XA Ref: 600	Vermont Ref: 610	Walnut Ref: 603	Mahogany Ref: 602	Dark Oak Ref: 604

Oregon Ref: 606	Structured Pine Ref: 608	Golden Oak Ref: 601	Douglas Fir Ref: 607	Macore Ref: 605

OTHERS

Quartz Grey Satin Ref: 625	Dark Green Ref: 626	Steel Blue Ref: 627	Structured Rouge Ref: 624	Structured Dark Brown Ref: 628

Structured Brilliant White Ref: 621	Structured White Ref: 622	Structured Agate Grey Ref: 623	Structured Beige Ref: 629	Structured Quartz Grey Ref: 630

Metbrush Anthracite Ref: 615	Alux DB 703 Ref: 616	Anthracite Satin Ref: 611	Structured Anthracite Ref: 612

RANGE OF COLOURS - PVC

* All these colours are available only for PVC windows.

● - All colours indicated with this symbol are "Cool Colors" TM

HANDLES - MODERN STYLE

WOOD AND WOOD-ALUMINIUM WINDOW HANDLES

Hoppe Atlanta (standard) Ref: 031



Hoppe Austin Ref: 032



PVC WINDOW HANDLES

Hoppe Luxembourg Ref: 033



ENTRANCE DOOR HANDLES

35A/1040 G6/S Ref: 034

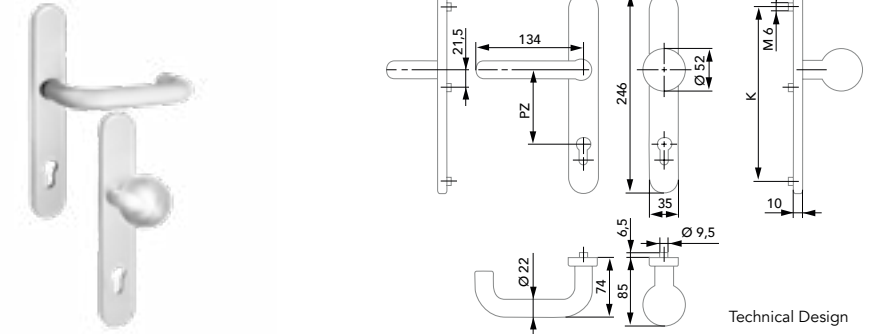

35A/1200 P Ref: 035

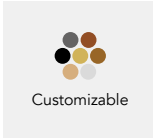
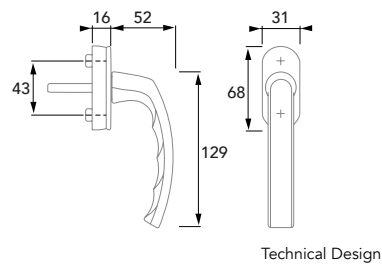
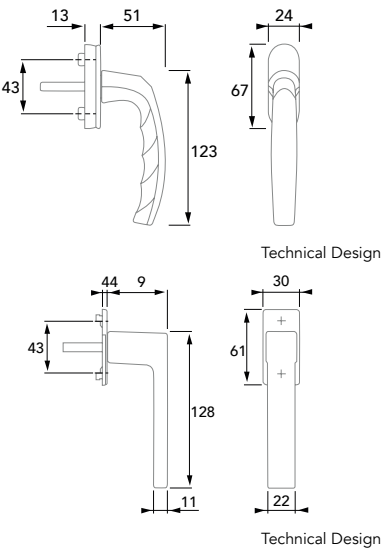
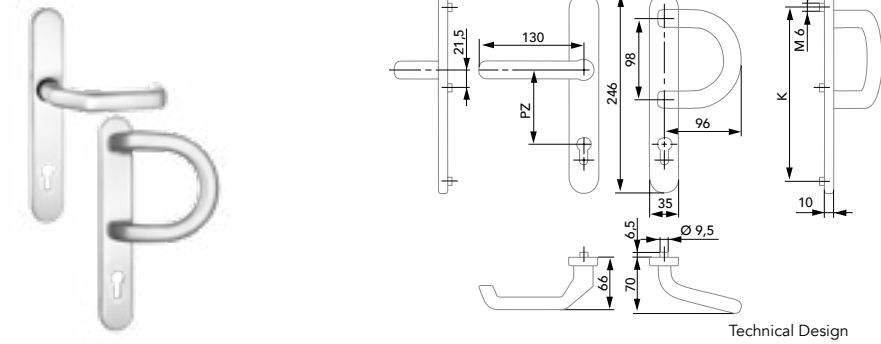

35A/1300 L1 Ref: 036



35A/1200 G1 Ref: 037



35A/1200 Ref: 038



35A/1200 G1/ZA Ref: 039

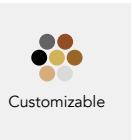
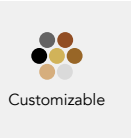
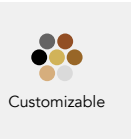
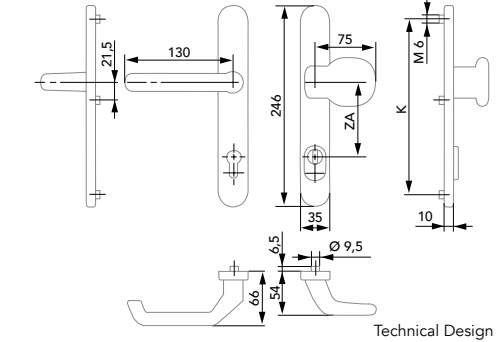
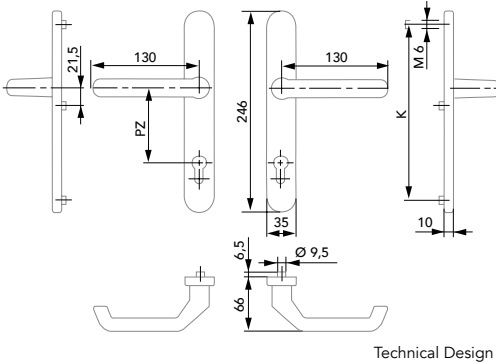
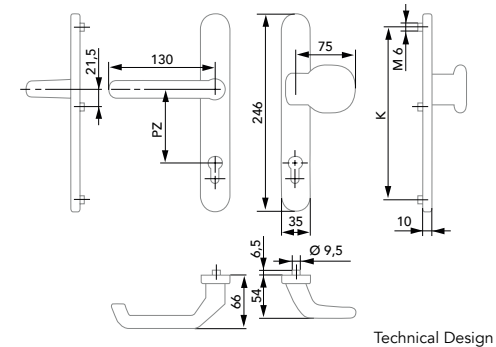
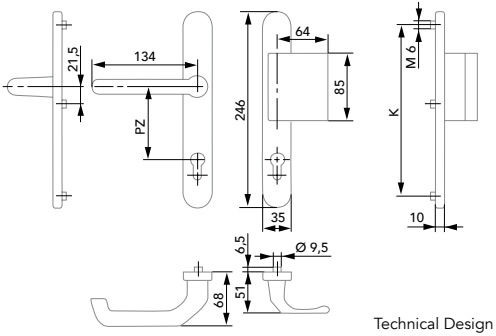

Colour range available for Entrance Doors

- RAL 9005 - Black
- RAL 9016 - White
- RAL 8019 - Brown
- F1 - Silver
- F2 - Champagne
- F3 - Gold
- F4 - Bronze
- F9 - Titanium

35A/1200 PZA Ref: 040

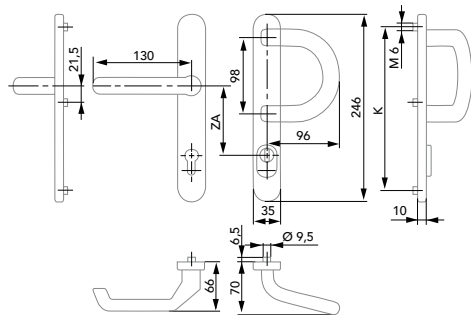

Technical Design

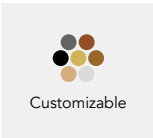

35A/2000 ZA Ref: 041

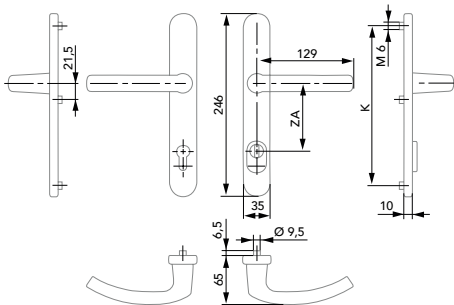

Technical Design

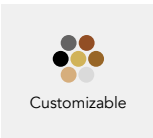

BI-FOLDING HANDLES

Ref: 042



VERTICAL BARS

Ref: 042

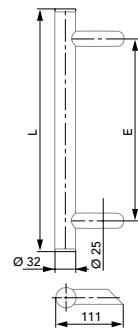
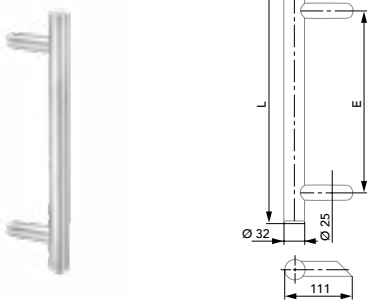

Technical Design

330 mm
400 mm
500 mm
600 mm
800 mm
1000 mm
1200 mm
1400 mm
1600 mm
1800 mm

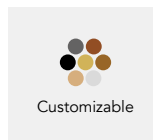

HANDLES - TRADITIONAL STYLE

WOOD AND WOOD-ALUMINIUM WINDOW HANDLES

Hoppe Singapore Ref: 043



Brass



Silver



Antique Brass

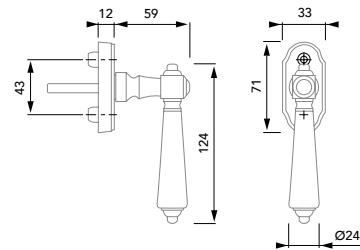

Technical Design

WOOD AND WOOD-ALUMINIUM BALCONY DOOR HANDLES

Hoppe Singapore Ref: 044



Brass



Silver



Antique Brass

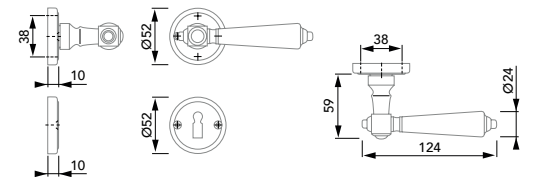

Technical Design

Hoppe Elba Ref: 045



Brass



Antique Brass

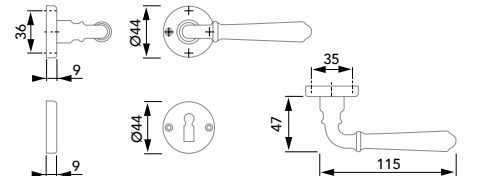

Technical Design

LIFT & SLIDE HANDLES

Hoppe Amsterdam Ref: 040

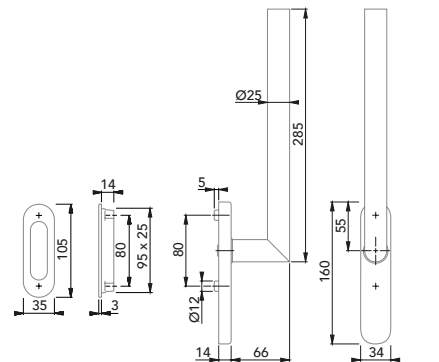

Technical Design



Hoppe Atlanta Ref: 040

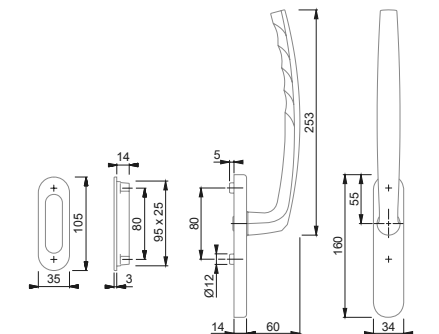

Technical Design



Colour range available for Entrance Doors

- RAL 9005 - Black
- RAL 9016 - White
- RAL 8019 - Brown
- F1 - Silver
- F2 - Champagne
- F3 - Gold
- F4 - Bronze
- F9 - Titanium

FRENCH STYLE HANDLES FOR WOOD WINDOW

Fausse Crémone Arinov Ref: 046



VERTICAL HANDLES FOR WOOD AND WOOD-ALUMINIUM WINDOW

Hoppe M476/15 Ref: 047

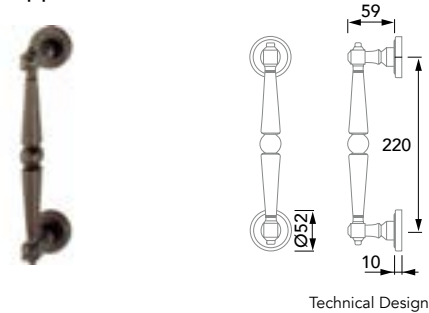

Hoppe 509 Ref: 048

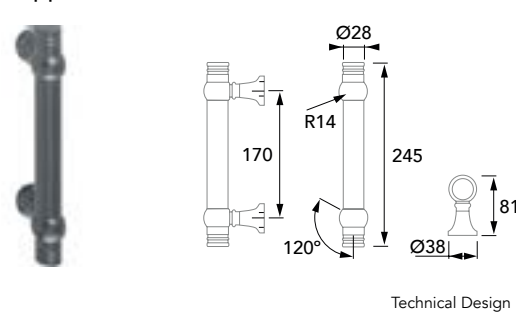

KNOB FOR WOOD DOOR

Arinov door knocker Ref: 049

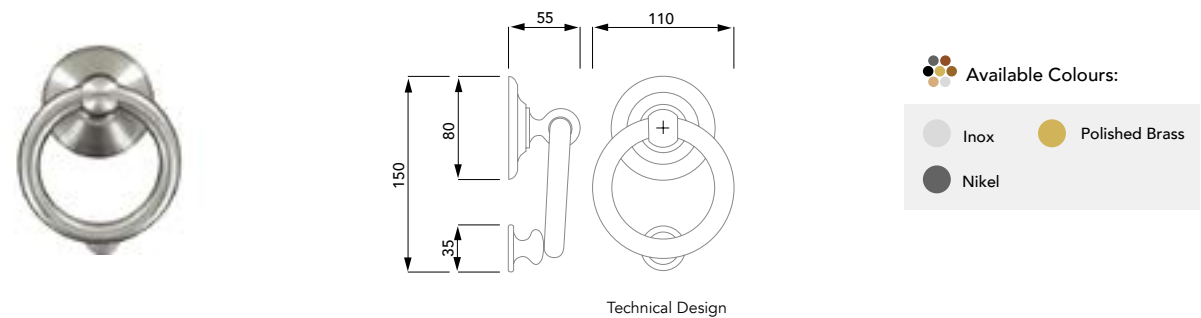

DOOR VIEWERS AND PEEPHOLES FOR WOOD DOOR

Arinov door viewers

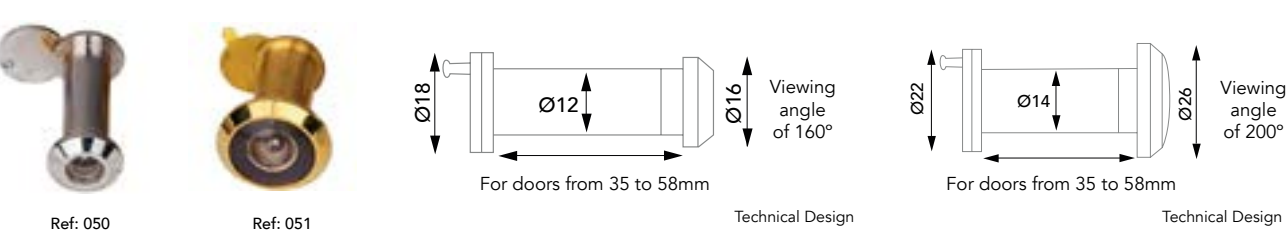

TYPE OF INSTALLATION

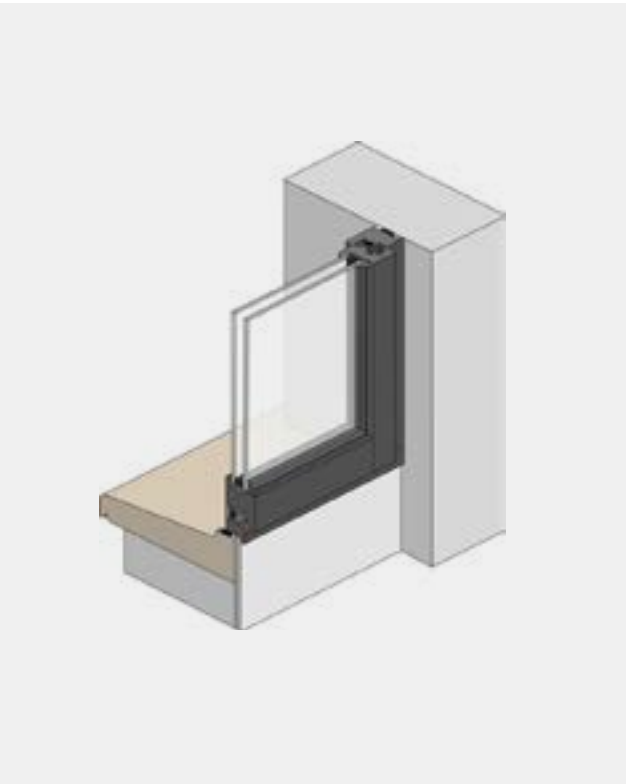
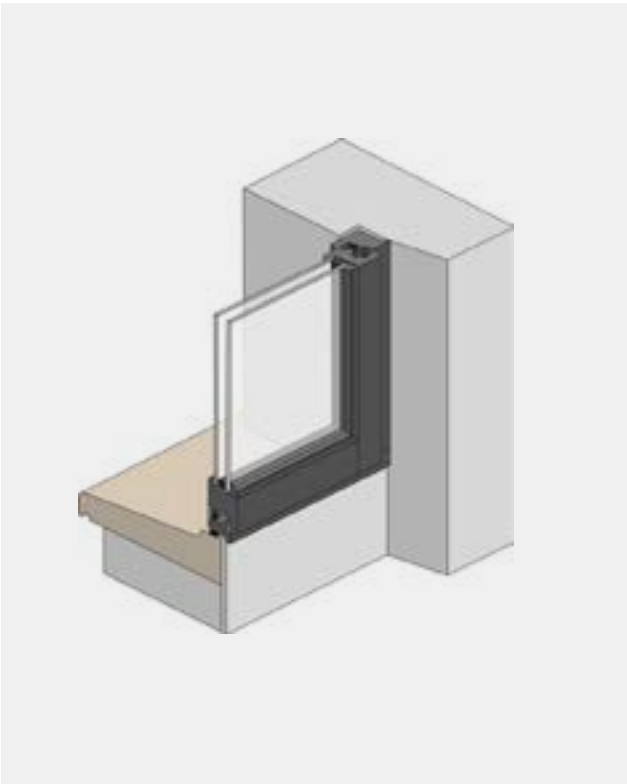
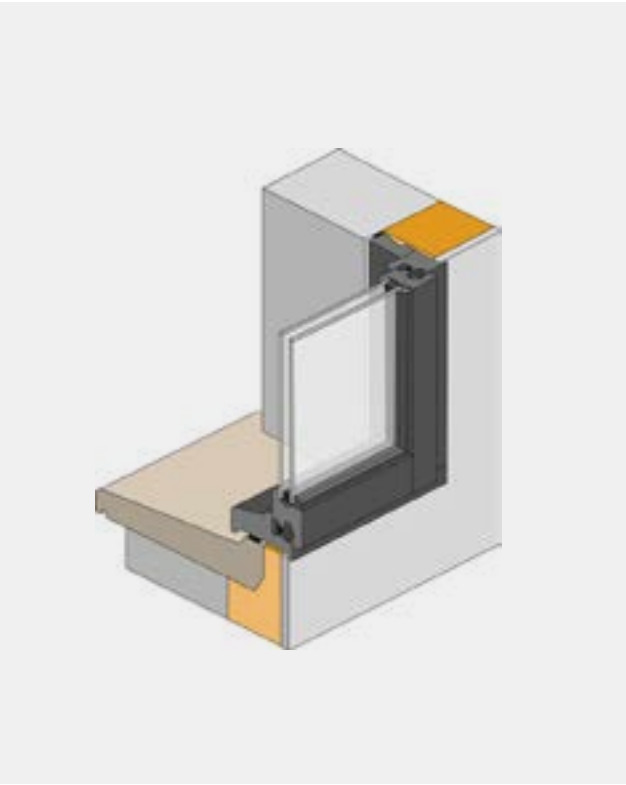
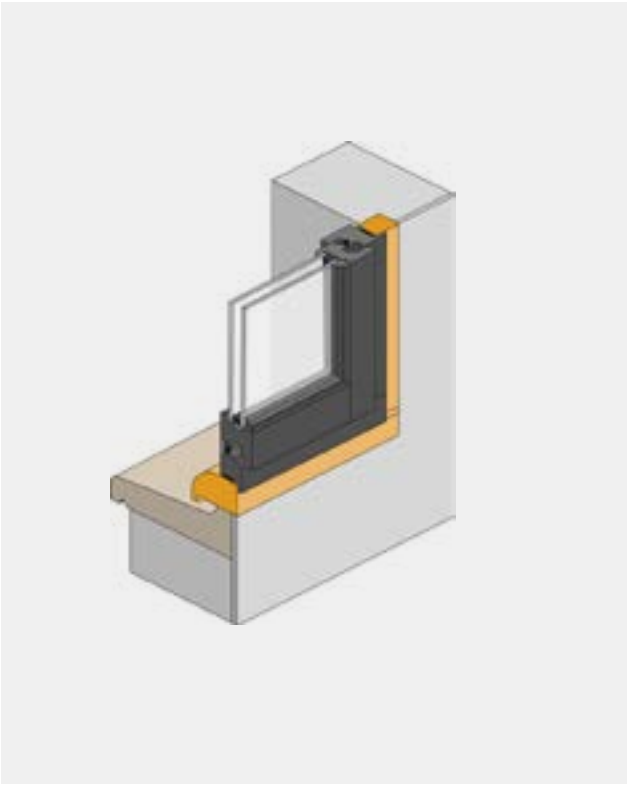

MAINTENANCE OF WINDOW
TIPS AND RECOMMENDATIONS



MAINTENANCE OF PROFILES

PVC

- Clean with soapy water;
- Rinse and dry cleaned areas (do not use abrasive products).

WOOD

- Clean with a soft, damp cloth and then wipe a dry cloth.

MAINTENANCE OF GLAZING

- The glass should be cleaned using a soft, non-abrasive cloth and with a glass cleaner.

MAINTENANCE OF HARDWARE

- Lubricate all moving parts and closing points;
- Check for a good operation.

Frequency - 2 times/year.

ENVIRONMENT	CLEANING FREQUENCY
Rural areas	2 times/year
Urban areas	3 times/year
Coastal and industrial zones	4 times/year

MAINTENANCE KIT

Special cleaner
Effectice cleaning action.
Ideal preparation for Sikkens Protector.
Dries with no residue.
Effective on the surface.
Water-borne.
Removes ballpoint pen, ink, pencil and rubber marks from PVC and metal.



Maintenance protector for windows
Water-repellent and soil-resisting.
Extends maintenance periods.
Freshens colour intensity and sheen.
Environmentally sound.
Easy to use.
Application without sanding or masking with tape.
Quick drying.
No need to buff or polish after application.

The sponge
To be used with the Protector on the window.
Soak the sponge in water.
Clean before use.
Rinse well after use.

MESTRE RAPOSA WARRANTY



Profile in PVC, Wood & Wood-Aluminium	10 years
Hardware	2 years
Glass	2 years
Roller Shutters/Shutters - Closing or Sliding	2 years

See the full version of the warranty of general conditions of sale.

The warranty period starts with the date of delivery and receipt of full payment of goods. Any manufacturing defect shall be communicated immediately after delivery.

- This warranty is for a period of 10 years for profiles and 2 years for hardware, glass and shutters. (Wooden and wood-aluminium windows, balcony doors, sliding doors, entrance doors, blinds and shutters).
- For directly provided products (PVC windows, PVC doors and blinds), any manufacturer’s warranty will apply.
- For the warranty request to be considered, notification must be made in writing and must be made in a timely fashion.

The warranty will apply only if the following conditions have been met:

- The elements were fitted professionally and in accordance with the current state of technology.
- The elements must be subject to an annual professional maintenance.
- The protective film must be removed from the frame/wing not later than 3 months after delivery.

The warranty is nullified if:

- The incorrect storage of the product caused the malfunction.
- Caused by the normal use of the goods or negligence or lack of maintenance by the buyer.
- Bumps or scratches that occured after their installation and during any construction period.
- Any modifications made to the elements and not previously authorized by Mestre Raposa will result in the cancellation of the warranty.



INDEX

Address:
Quatro Estradas, E.N.125
Loulé, Portugal

T: +351 289 355 420
E: info@mestreraposa.com

facebook.com/mestreraposa
www.mestreraposa.com